

KAWASAKI Z900 '20- '24

M O U N T I N G I N S T R U C T I O N S

REF 22901

D12 SPOILERS



1 Person



20 min



EASY



PHILLIPS
SCREWDRIVER



ALLEN

Nº 3
Nº 4



ID	PIEZA/PART	DESCRIPCIÓN	DESCRIPTION	QTY	REF
1		Alerón D12 izquierdo	Left D12 spoiler	1	22901J/N/C/SM3
2		Alerón D12 derecho	Right D12 spoiler	1	22901J/N/C/SM3
3		Soporte izquierdo (L)	Left support (L)	1	SOPOR2P2-L22901
4		Soporte derecho (R)	Right support (R)	1	SOPOR2P2-R22901
5		Casquillo Ø9x Ø6,5x 6,5mm	Ø9x Ø6,5x 6,5mm Arrowhead	2	CASQUI-----0046
6		Tornillo roscachapa Ø5x25 DIN7505B punta forma F	Ø5x25 DIN7505B Phillips screw	2	TORNI-D7505-754
7		Tornillo Allen M6X25 Ø14 ISO7380	M6X25 Ø14 ISO7380 Allen screw	2	TORNI-I7380-405
8		Casquillo Ø8,5 x Ø14 x3,5mm	Ø8,5 x Ø14 x3,5mm Arrowhead	2	CASQUI-----182
9		Tornillo Allen M5x16 DIN7991	M5x16 DIN7991 Allen screw	4	TORNI-D7991-867
10		Arandela de goma Ø4,5 x Ø11 x 2mm	Ø4,5 x Ø11 x 2mm Rubber washer	4	ARAND-EPDM--722
11		Tuerca M5 DIN6923	M5 DIN6923 Nut	4	TUERC-D6923-255
12		Tapón tornillo M5 DIN7991	M5 DIN7991 screw cap	4	TAPON-----92

KAWASAKI Z900 '20- '24

INSTRUCCIONES DE MONTAJE - MOUNTING INSTRUCTIONS - MONTAGEANLEITUNG

Se muestra el montaje del lado izquierdo a modo de ejemplo, realizar los mismos pasos para el montaje del lado derecho.
The Left side assembly is shown as an example, so the same steps can be performed for the right side assembly.

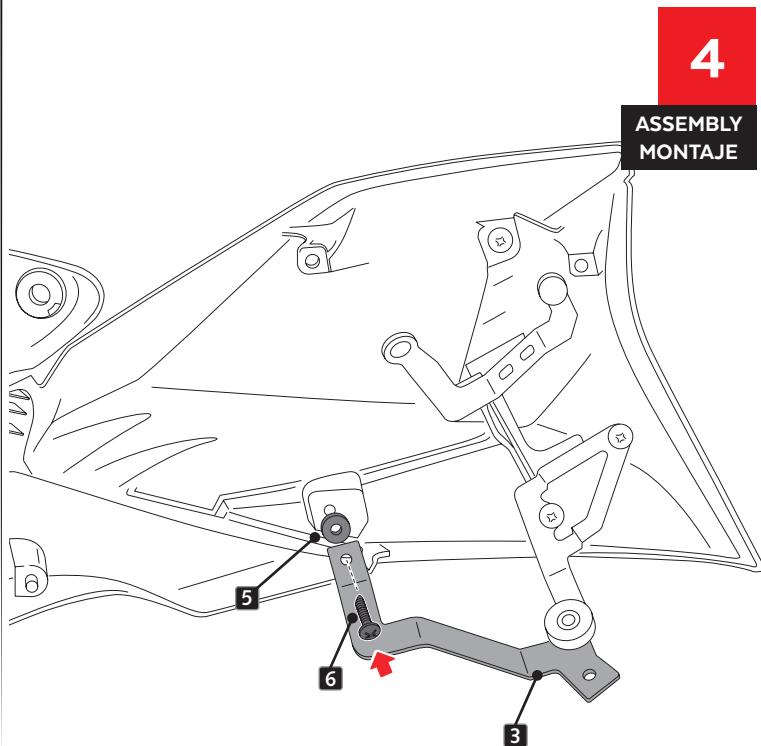
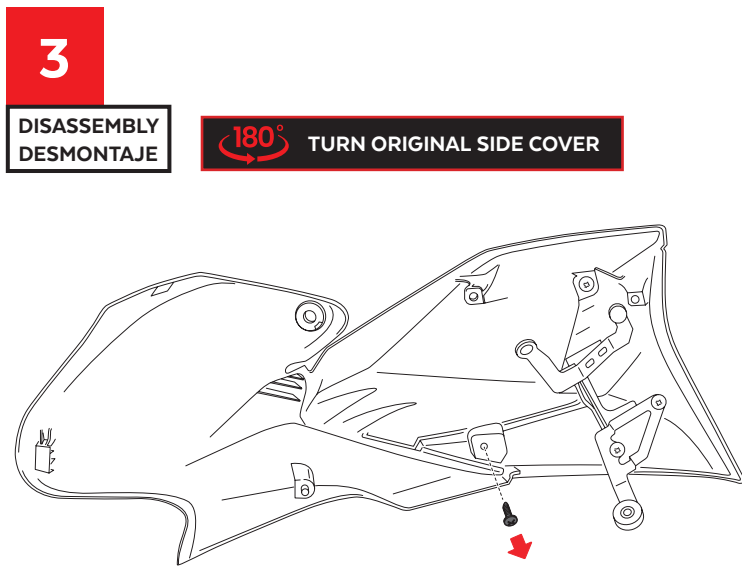
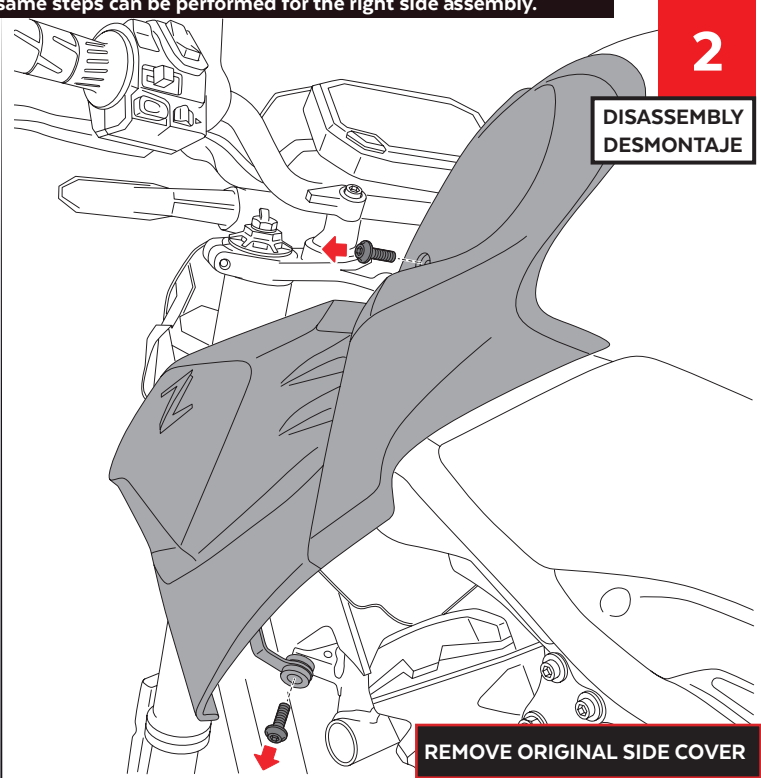
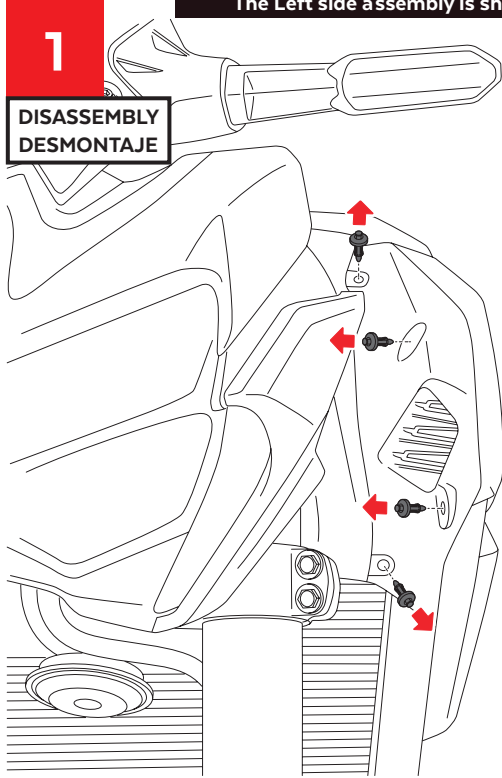

KAWASAKI Z900 '20- '24

INSTRUCCIONES DE MONTAJE - MOUNTING INSTRUCTIONS - MONTAGEANLEITUNG

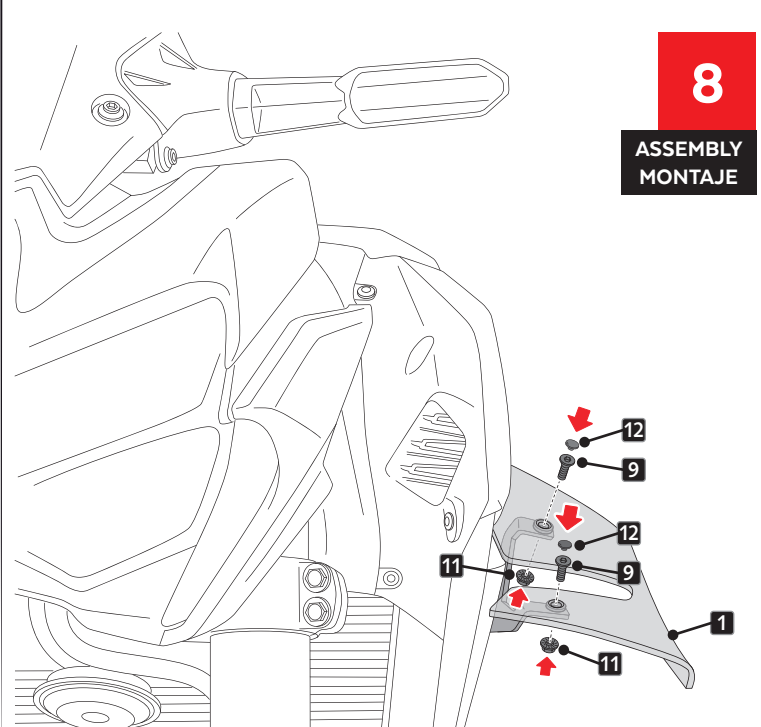
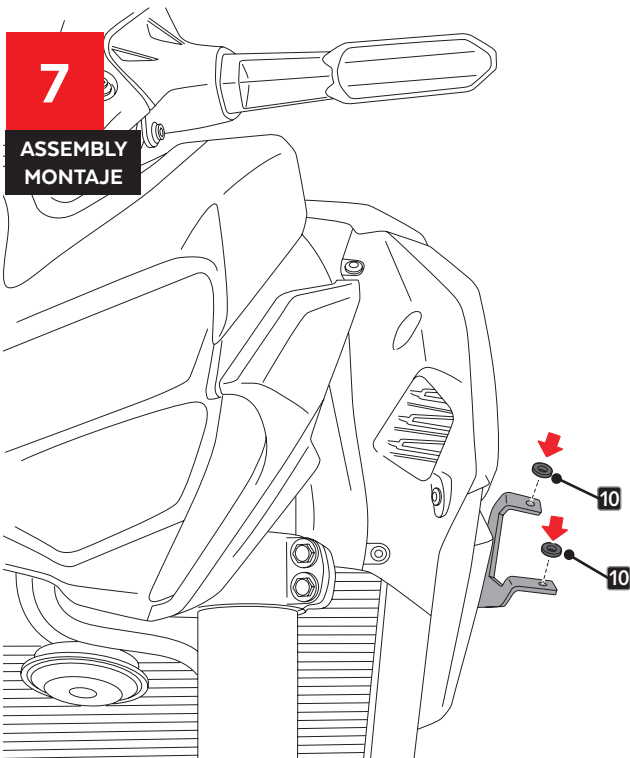
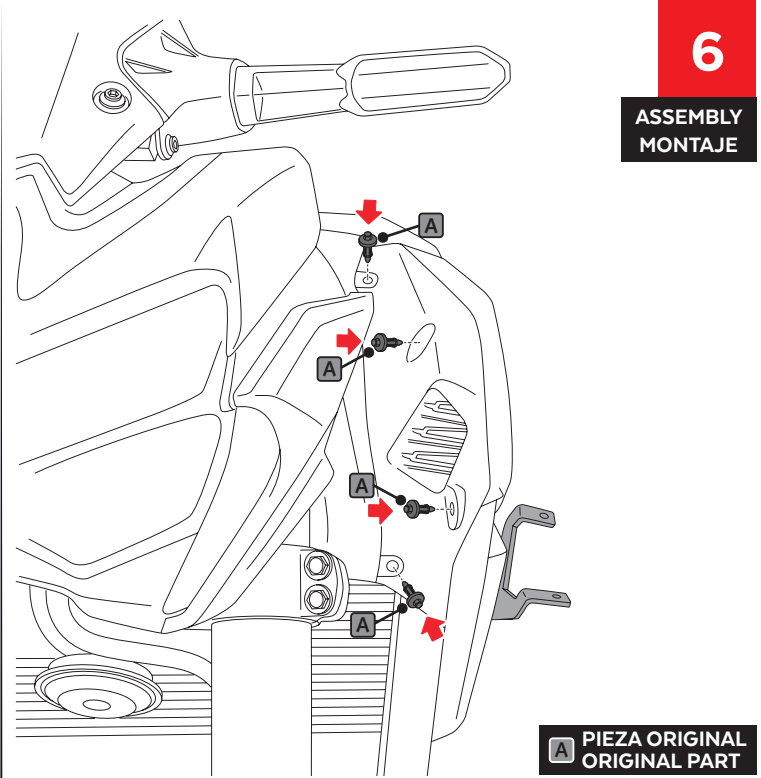
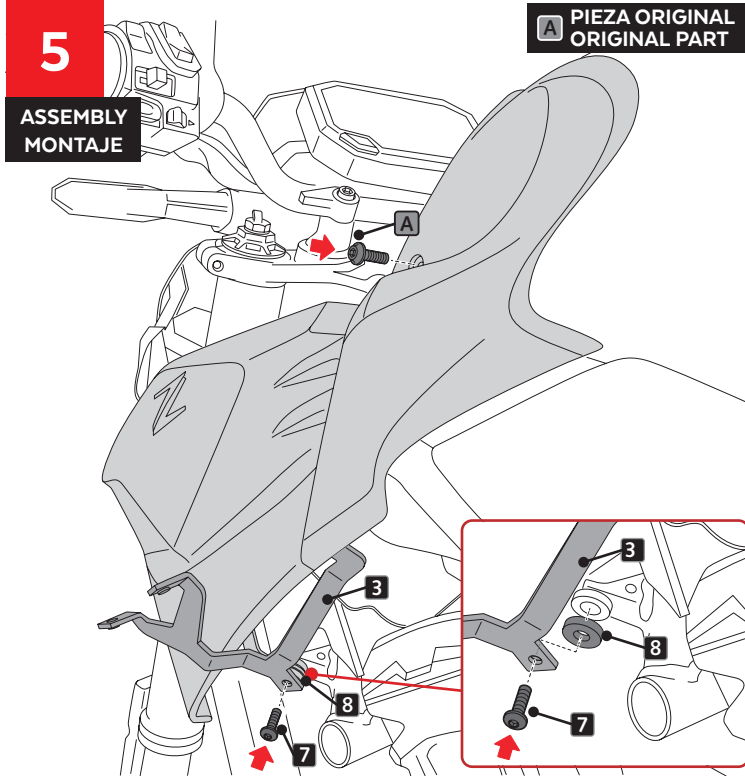

SI ES NECESARIO, AFLOJAR TUERCAS ID.11 Y AJUSTAR LA POSICIÓN DEL ALERÓN.
IF IT'S NECESSARY, LOOSEN ID.11 NUTS AND ADJUST THE POSITION OF THE SPOILER.